



# CuratOR® SC430-PTR

4K/60p Surgical Field Camera System



Ultra-High Definition Camera System  
with Integrated Triaxial Mount  
for Capturing Surgical Proceedings

4K



Capturing surgical proceedings in detail is vital for various purposes. The CuratOR SC430-PTR clearly captures the surgical field in 4K UHD resolution, and comes fully integrated with a triaxial camera mount for versatile positioning.

### 4K Ultra-High Definition Resolution

The surgical field camera captures images in 4K UHD resolution (3840 x 2160) with a progressive 60 Hz signal for smooth, high definition images of the surgical site.

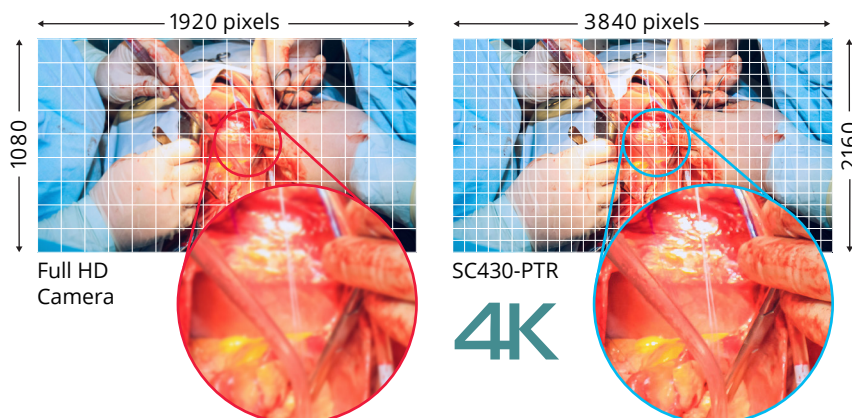

### Zoom into Narrow Target Areas in Detail

The camera lens has up to 30x optical zoom, allowing the camera to easily zoom into small, target areas. Even when positioned at a safe distance, the camera can clearly zoom into and capture narrow surgical sites in detail.

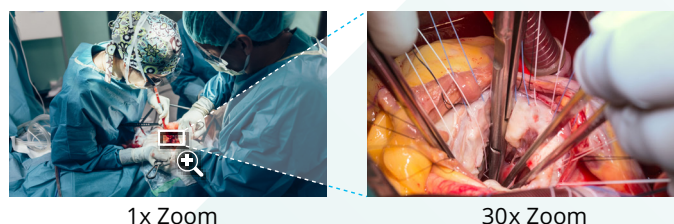

### Smooth Positioning at High Zoom

With unique and intelligent stepping technology, as the camera zooms in, the pan, tilt, and roll movements slow down to prevent the field of view from moving too quickly. With easily controllable movements, even under high zoom, preparation for surgery is made quicker and easier.



Movement



Without Stepping

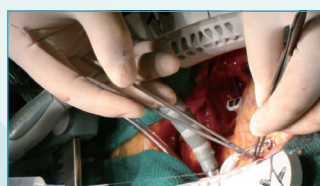

With Stepping

### Fully Integrated Camera Mount

The camera head comes fully integrated on a camera mount with  $\pm 170$  degrees pan,  $+90$  to  $-30$  degrees tilt, and  $\pm 165$  degrees roll to ensure that the field of view can be adjusted to the ideal location with ease.

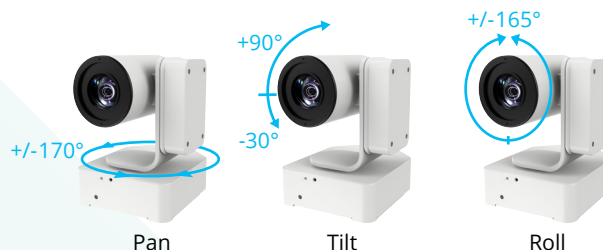

### Intuitive Panning and Tilting Direction

The camera head is integrated with the camera mount, allowing for left and right, and up and down movements to remain parallel to the field of view, even after rolling. When panning or tilting, the camera head moves in relation to the field of view, rather than the position of the camera head like unintegrated cameras. This ensures intuitive and effortless panning and tilting.

*On typical camera mounts, roll and pan functions operate independently, which can sometimes make it difficult to move the camera in the intended direction.*

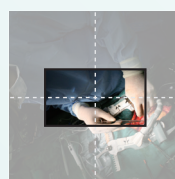

Preview

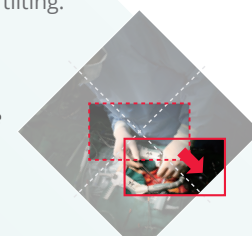

Without Integrated Camera Mount

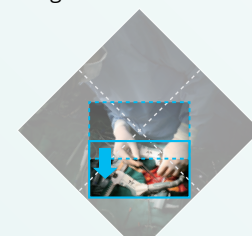

With Integrated Camera Mount

## Convenient Camera Control from Anywhere

Camera movement, focus, and white balance can be adjusted using the front panel of the Camera Control Unit (CCU), or the supplied wireless remote control. Additionally, the CCU panel and optional wired remote control come with a joystick for intuitive control. The camera can also be controlled from OR software, such as CuratOR Calip.

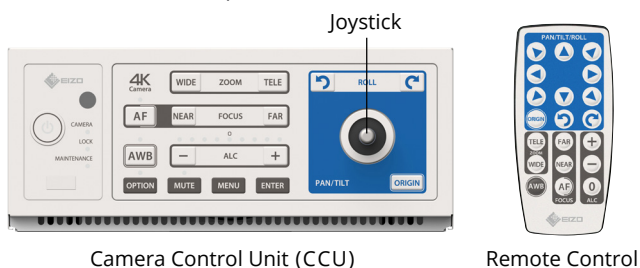

## Versatile Connectivity

The SC430-PTR comes with 3G-SDI and HDMI output terminals, for outputting 4K or full HD video at 60p/50p.

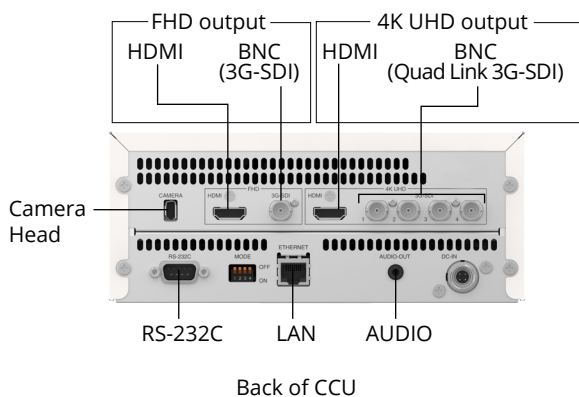

## Voice Capture for Comprehensive Review

When reviewing surgical footage, audio is often required to hear how the doctors and nurses communicate. The SC430-PTR records sound at the same time as video, providing a high definition video with synced audio. This allows viewers to clearly hear and see the proceedings of a surgery.



## Obstruction-Free Viewing

Typical surgical field cameras attach to the center of surgical lights, where the surgeon's head or arms may obstruct the field of view. The SC430-PTR can be attached to designated ceiling arms, allowing it to be positioned independent of lighting to avoid possible obstructions.



## One Cable Connection for Easy Installation

The integrated camera head and mount can be connected to the CCU via a single cable which not only supplies video and audio, but also power. This makes installation quick and easy, as well as reduces cable clutter.

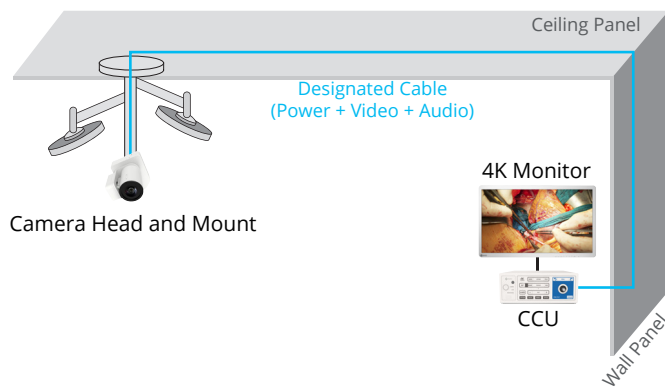

Installation Example

## Easy Cleaning

The exterior can be safely sterilized with alcohol.

## Rest Assured with Medical Qualifications

The SC430-PTR meets strict medical, safety and EMC emission standards.

# CuratOR® SC430-PTR

## Specifications

|                      |                                  |  |
|----------------------|----------------------------------|--|
| Camera Head          | Image Sensor                     | 1/2.5 type CMOS, single chip type  |
|                      | Effective Pixels                 | 3840 x 2160  |
|                      | Zoom                             | Optical 30x motorized zoom   |
|                      | Focal Length (f=)                | 4.6 (W) - 135 (T) mm   |
|                      | Horizontal Field of View (HFOV)  | 68 (W) - 2.6 (T) deg.  |
|                      | Minimum Object Distance (M.O.D.) | 1500 mm (throughout the zoom range)<br>1000 mm (with Close-up lens)  |
|                      | Filter Diameter                  | 72 mm  |
|                      | Focus Control                    | Auto, Manual   |
|                      | Iris Control                     | Auto, Manual   |
|                      | Pan Range                        | +/-170 deg.  |
|                      | Tilt Range                       | +90 / -30 deg.   |
|                      | Roll Range                       | +/-165 deg.  |
|                      | Pan Speed                        | 8.6 - 0.05 deg/s, 7 steps  |
|                      | Tilt Speed                       | 8.6 - 0.05 deg/s, 7 steps  |
|                      | Roll Speed                       | 30 - 0.2 deg/s, 7 steps  |
|                      | Built-in microphone              | Yes  |
| Features & Functions | Image Control                    | Auto Level Control (ALC), Center Weighting Metering, BT.2020 Emulation, White Balance, Sharpness   |
|                      | Gain                             | Auto, Manual (0 - 45 db)   |
|                      | Shutter Speed                    | [59.94 Hz output] 1/60 - 1/10000<br>[50 Hz output] 1/50 - 1/10000  |
|                      | Picture Flip                     | Normal, Flip   |
| Video Format         | 4K UHD                           | HDMI: 2160/59.94p, 2160/50p<br>SDI: 2160/59.94p, 2160/50p  |
|                      | FHD                              | HDMI: 1080/59.94p, 1080/59.94i, 1080/50p, 1080/50i<br>SDI: 1080/59.94p, 1080/59.94i, 1080/50p, 1080/50i  |
| General              | Output Terminals                 | HDMI x2, BNC (Quad Link 3G-SDI), BNC (3G-SDI), Audio   |
|                      | Remote Control                   | LAN, RS-232C, IR remote  |
|                      | Power Requirements               | DC 24 V (bundled AC adapter)   |
|                      | Maximum Power Consumption        | 55 W   |
|                      | Dimensions                       | Camera Head and Mount: 162(W) x 211.5(H) x 198(D) mm (with cable cover)<br>Camera Control Unit: 212(W) x 87.5(H) x 270(D) mm (without projection and rubber feet)                    |
|                      | Net Weight                       | Camera Head and Mount: 3.1 kg (with cable cover)<br>Camera Control Unit: 2.9 kg  |
|                      | Hole Spacing                     | Camera Mount: 100 x 100 mm   |
|                      | Operating Temperature            | Camera Head and Mount: 0 - 40°C<br>Camera Control Unit: 0 - 40°C   |
|                      | Operating Humidity               | 20 - 80%RH   |
|                      | Certifications & Standards       | IEC60601-1, CE, CB, FCC-A, CAN ICES-3 (A), RoHS, WEEE  |
|                      | Supplied Accessories             | AC adapter, AC power cord (2 m), Camera cable (25 m), IR remote, Rubber feet x 4, ND filter, Close-up lens, Cable cover, Thread-locking fluid, Instructions for Use, Quick Reference |
|                      | Warranty                         | 2 Years  |

## Dimensions (Unit : mm)

### Camera Head and Mount

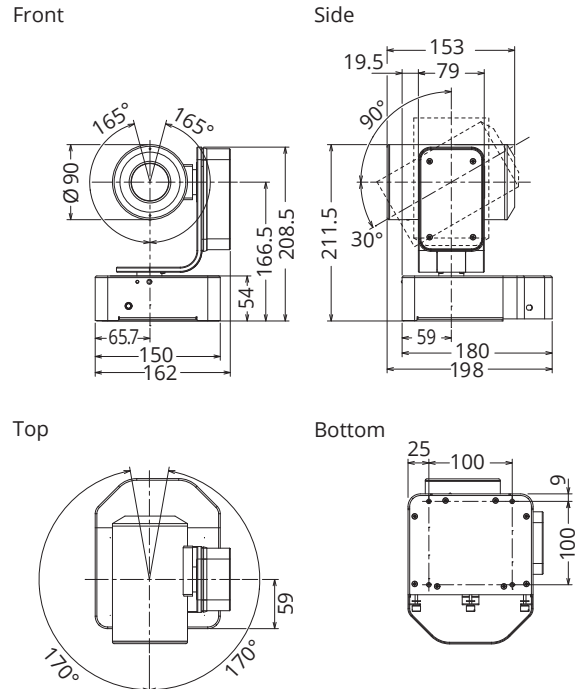

### Camera Control Unit (CCU)

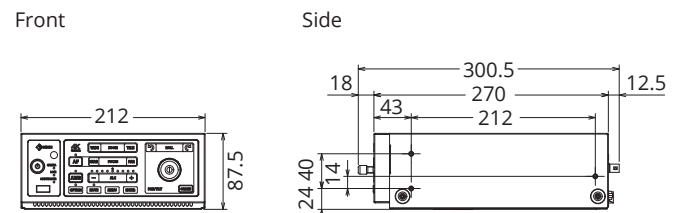

## Accessory

### The Ideal Cable for Compact Environments

A 5 meter camera cable for connecting the SC430-PTR Camera Head to the Camera Control Unit (CCU). The short length is perfect for compact environments where the camera and CCU are positioned near each other, to eliminate surplus cable length.

Short Camera Cable  
for Surgical Field Camera System

## SCC500



You will find your EIZO contact partner at:  
[www.eizo-or.com/contact](http://www.eizo-or.com/contact)

All product names are trademarks or registered trademarks of their respective companies. EIZO, the EIZO Logo, and CuratOR are registered trademarks of EIZO Corporation. Specifications are subject to change without notice.